

PRODUCED BY AN AUTODESK EDUCATIONAL PRODUCT

PRODUCED BY AN AUTODESK EDUCATIONAL PRODUCT

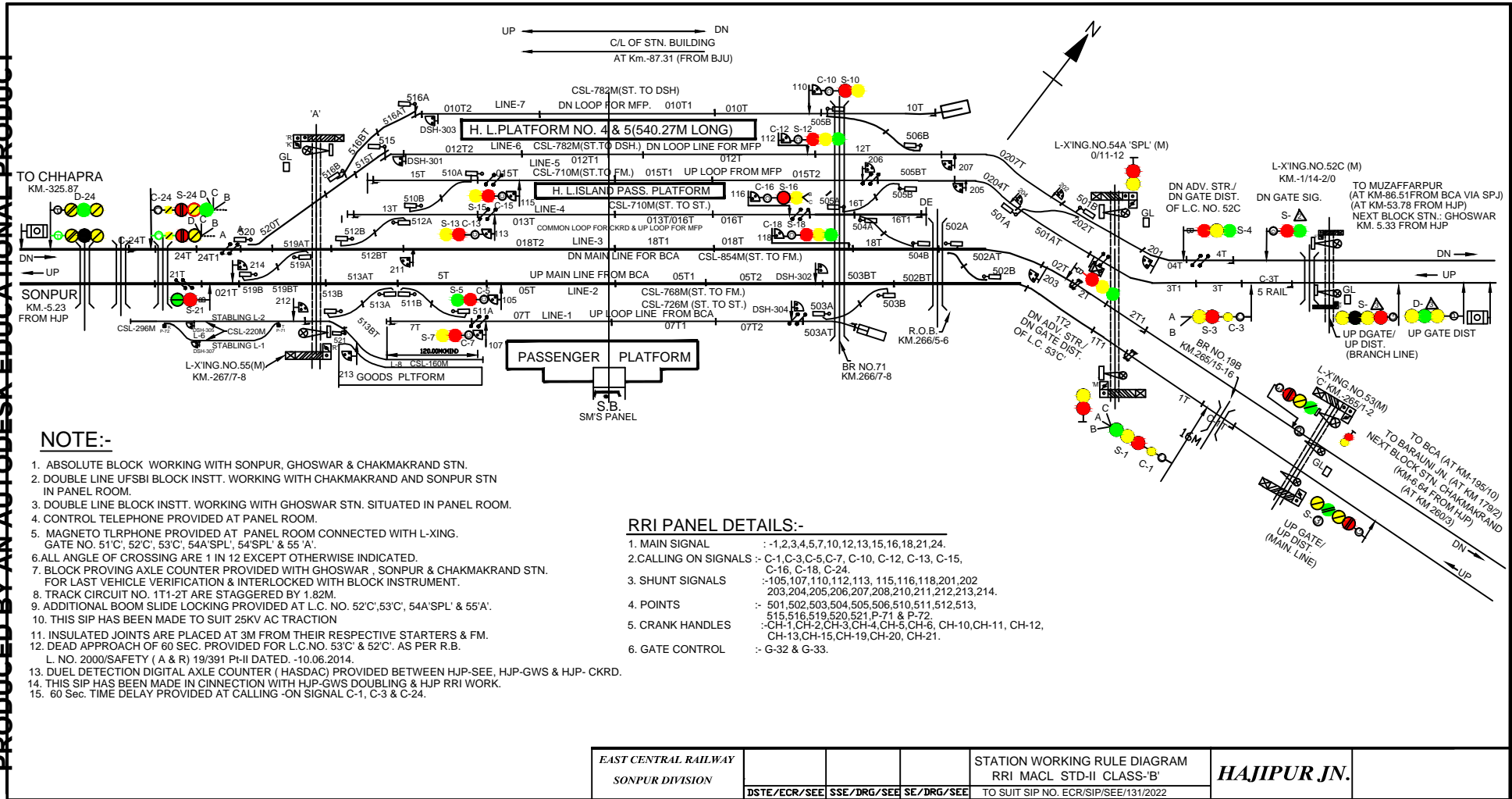

NOTE:-

1. ABSOLUTE BLOCK WORKING WITH SONPUR, GHOSWAR & CHAKMAKRAND STN.
2. DOUBLE LINE UFSBI BLOCK INSTT. WORKING WITH CHAKMAKRAND AND SONPUR STN IN PANEL ROOM.
3. DOUBLE LINE BLOCK INSTT. WORKING WITH GHOSWAR STN. SITUATED IN PANEL ROOM.
4. CONTROL TELEPHONE PROVIDED AT PANEL ROOM.
5. MAGNETO TLRPHONE PROVIDED AT PANEL ROOM CONNECTED WITH L-XING. GATE NO. 51'C, 52'C, 53'C, 54A'SPL', 54'SPL' & 55'A'.
6. ALL ANGLE OF CROSSING ARE 1 IN 12 EXCEPT OTHERWISE INDICATED.
7. BLOCK PROVING AXLE COUNTER PROVIDED WITH GHOSWAR, SONPUR & CHAKMAKRAND STN. FOR LAST VEHICLE VERIFICATION & INTERLOCKED WITH BLOCK INSTRUMENT.
8. TRACK CIRCUIT NO. 1T1-2T ARE STAGGERED BY 1.82M.
9. ADDITIONAL BOOM SLIDE LOCKING PROVIDED AT L.C. NO. 52'C, 53'C, 54A'SPL' & 55'A'.
10. THIS SIP HAS BEEN MADE TO SUIT 25KV AC TRACTION
11. INSULATED JOINTS ARE PLACED AT 3M FROM THEIR RESPECTIVE STARTERS & FM.
12. DEAD APPROACH OF 60 SEC. PROVIDED FOR L.C.NO. 53'C & 52'C. AS PER R.B. L. NO. 2000/SAFETY (A & R) 19/391 Pt-II DATED. -10.06.2014.
13. DUEL DETECTION DIGITAL AXLE COUNTER (HASDAC) PROVIDED BETWEEN HJP-SEE, HJP-GWS & HJP- CKRD.
14. THIS SIP HAS BEEN MADE IN CINNECTION WITH HJP-GWS DOUBLING & HJP RRI WORK.
15. 60 Sec. TIME DELAY PROVIDED AT CALLING -ON SIGNAL C-1, C-3 & C-24.

RRI PANEL DETAILS:-

1. MAIN SIGNAL :- 1,2,3,4,5,7,10,12,13,15,16,18,21,24.
2. CALLING ON SIGNALS :- C-1,C-3,C-5,C-7, C-10, C-12, C-13, C-15, C-16, C-18, C-24.
3. SHUNT SIGNALS :- 105,107,110,112,113, 115,116,118,201,202 203,204,205,206,207,208,210,211,212,213,214.
4. POINTS :- 501,502,503,504,505,506,510,511,512,513, 515,516,519,520,521,P-71 & P-72.
5. CRANK HANDLES :- CH-1,CH-2,CH-3,CH-4,CH-5,CH-6, CH-10,CH-11, CH-12, CH-13,CH-15,CH-19,CH-20, CH-21.
6. GATE CONTROL :- G-32 & G-33.

EAST CENTRAL RAILWAY SONPUR DIVISION				STATION WORKING RULE DIAGRAM RRI MACL STD-II CLASS-B TO SUIT SIP NO. ECR/SIP/SEE/131/2022	HAJIPUR JN.
	DSTE/ECR/SEE	SSE/DRG/SEE	SE/DRG/SEE		