

KIUL-GAYA SECTION

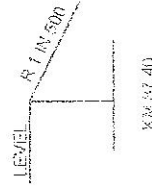

CLASS OF STATION: 'B1'
STD OF INTERLOCKING : IRI
SIGNAL : MACL
ABOVE M.S.L. :

C. OF TILAIYA STATION (TIA)
 AT Km.- 87.83 (FROM KIUL)

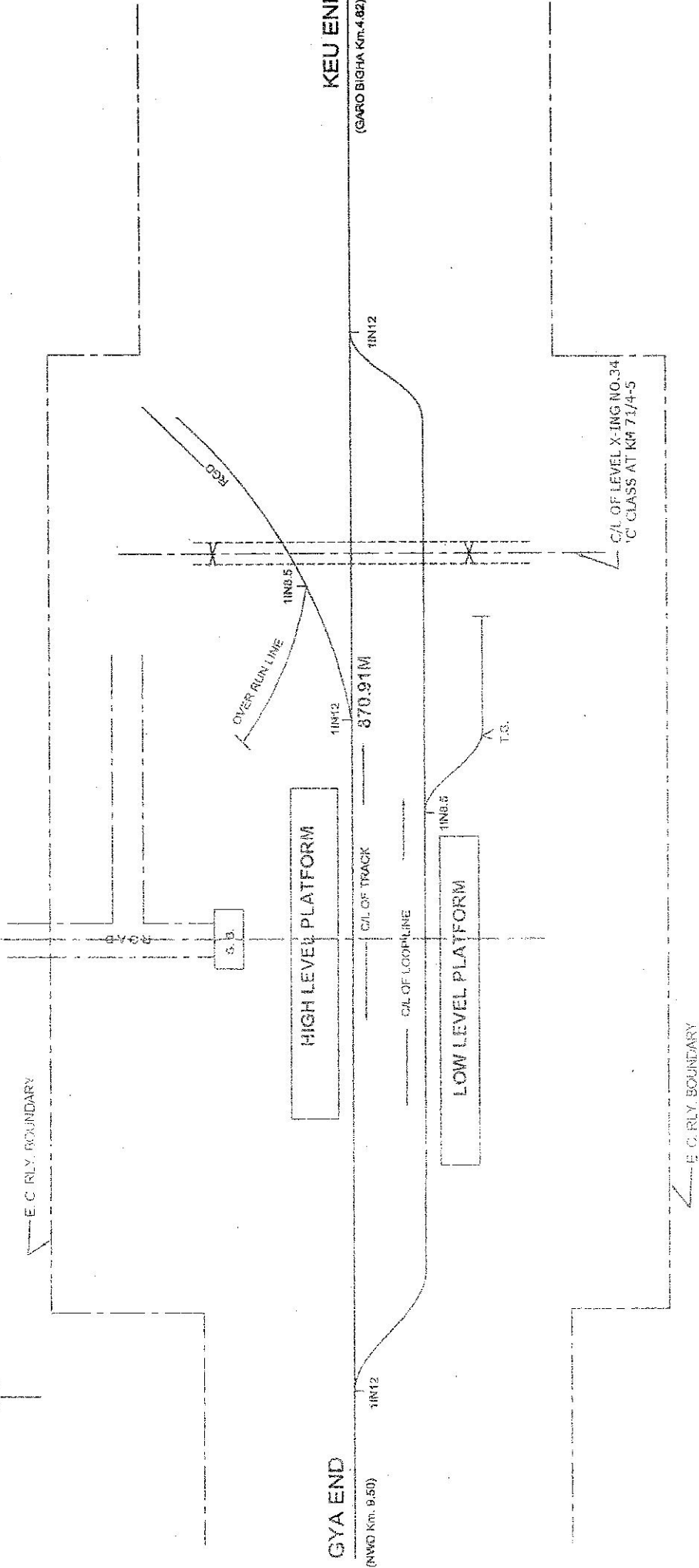

EAST CENTRAL RAILWAY
 DANAPUR DIVISION
 ENGINEERING STATION YARD DIAGRAM
TILAIYA STATION AT KM-87.83

NOT TO SCALE