

# MEHSIL STATION

एगल ह लव्सकु

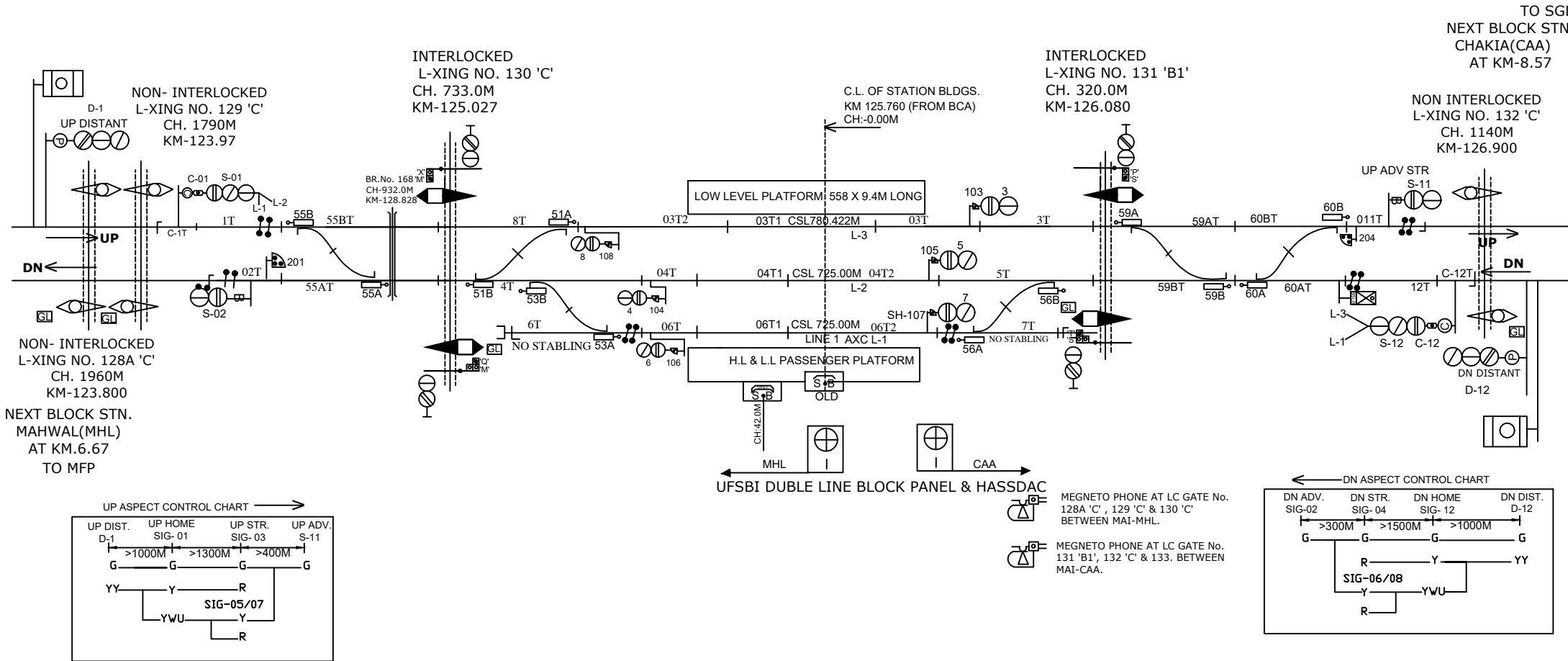
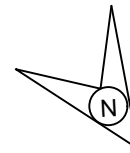

TO SGL  
NEXT BLOCK STN.  
CHAKIA(CAA)  
AT KM-8.57

NON- INTERLOCKED  
L-XING NO. 129 'C'  
CH. 1790M  
KM-123.97

INTERLOCKED  
L-XING NO. 130 'C'  
CH. 733.0M  
KM-125.027

INTERLOCKED  
L-XING NO. 131 'B1'  
CH. 320.0M  
KM-126.080

NON INTERLOCKED  
L-XING NO. 132 'C'  
CH. 1140M  
KM-126.900

NON- INTERLOCKED  
L-XING NO. 128A 'C'  
CH. 1960M  
KM-123.800  
NEXT BLOCK STN.  
MAHWAL(MHL)  
AT KM.6.67  
TO MFP

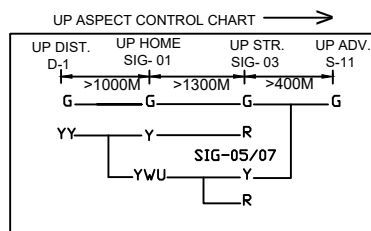

UFSBI DUBLE LINE BLOCK PANEL & HASSDAC

MEGNETO PHONE AT LC GATE No. 128A 'C', 129 'C' & 130 'C' BETWEEN MAI-MHL.  
MEGNETO PHONE AT LC GATE No. 131 'B1', 132 'C' & 133. BETWEEN MAI-CAA.

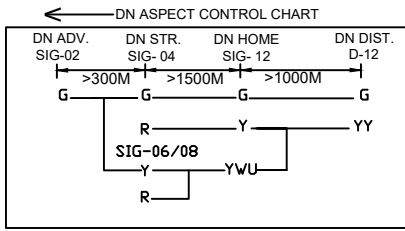

CLASS OF STATION : B  
STD OF SIG & INTERLOCKING: STD-II (R)

EAST CENTRAL RAILWAY SAMASTIPUR DIVISION	SR.DSTE/SPJ	DSTE/SPJ	JE/DRG	STATION WORKING RULE DIAGRAM MACL, STD-II (R), CLASS 'B'	MEHSI एगल ह	SWRD NO.-
						ECR/SWRD/SPJ- MAI/331/2022
TO SUIT SIP NO. ECR/SIP/SPJ-MAI/331/2021 ALT-A2						